



Item # 20139585, INSTA-LOCK Fitting TYPE C Female Coupler x Hose Shank C150AL w/ BR HANDLE 1 1/2 in Aluminum

APPLICATION: Type C fitting can be attached to a rubber hose with the use of interlocking ferrules, crimp sleeves, or bands. Insta-Lock™ fittings are designed for liquids and dry bulk. Consult the chemical resistance guide for specific chemical recommendations.

BRANDING: Example: Continental Contitech C200SS

PRESSURE RATING: Sizes 1/2"– 2", 250 psi; sizes 2 1/2"– 4", 150 psi; sizes 5"– 6", 75 psi. Recommended working pressure ratings based on ambient temperature (70 °F) with Standard Nitrile gaskets.

Note: Continental Contitech Insta-Lock Fittings are never to be used in steam or compressed air service. Continental Contitech Insta-Lock Cam Arms are designed exclusively for Insta-Lock fittings.

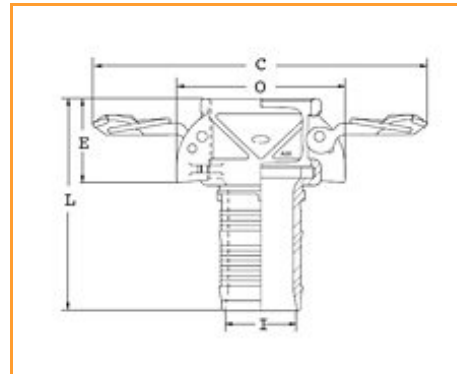

[Product Specifications](#) | [Specifications](#)

Product Specifications

| | |
|----------|----------------------------|
| Type | INSTA-LOCK™ Female Coupler |
| Style | TYPE C |
| Material | Aluminum |
| | |

| | |
|-------------------|--------------------|
| Brand | INSTA-LOCK™ TYPE C |
| Order Code | 650-827 |

Specifications

| | |
|--|-----------------------|
| End Type A | Female Coupler |
| End Size A | 1 1/2 |
| End Type B | Hose Shank |
| End Size B | 1 1/2 |
| C - Max. Width w/ Cam Arms Extended | 7.967 in 202.36 mm |
| L - Overall Length | 4.750 in 120.65 mm |
| I - Min. I.D. | 1.156 in |
| O - Max. Width w/ Cam Arms Closed | 3.830 in |
| E - Exposed Length | 2.370 in |
| Max. Working Pressure | 250.0 psi |
| Weight | 0.8000 lb |
| Order Increment | 1 |

MideastUS@contitech.us

1-800-235-4632

Contitech.us

ContiTech