

## FLK90 In-Line Cartridge Filters

**Working Pressures to:** 580 psi  
4002 kPa  
40 bar

**Rated Static Burst to:** 2000 psi  
13,790 kPa  
138 bar

**Flow Range To:** 40 gpm  
151 lpm



### IMPORTANT SERVICE INSTRUCTIONS:

To prevent thread damage when installing new filter, fully lubricate the entire thread and o-ring surface with a Molybdenum-containing gear oil or anti-seize paste such as Schaeffer #214S Supreme One 80W-140 gear oil or Dow Corning Molykote P-37 anti-seize past.

## Features

The FLK assembly is a robust, reusable housing and disposable cartridge design. The versatile FLK filter head accommodates multiple housing lengths. Industrial, raised hand grips make it easy to remove the housing from the head without the need for special servicing tools. The oil drain port on the bottom of the housing and the locking grab handles on the filter cartridge allow for cleaner, easier servicing. The filter tabs lock into place – simplifying positioning during reassembly. Short removal clearance is needed for filter replacement means the assembly can easily fit into tight spaces.

These assemblies utilize a unique sealing technology that protects systems from harmful ingressed contaminants and cross contamination of oil. The RadialSeal™ interface increases the surface area which provides a robust connection with superior vibration resistance, a common challenge in today's heavy-duty applications.

The FLK filters are offered with Synteq XP™ media, Donaldson's most advanced media technology. Each filter has extended surface area for advanced filtration performance. Synteq XP delivers better pressure drop and better contaminant holding capacity than standard filter media.

- Robust 4-point mount
- Oil drain port
- Optional 2-point mount
- Heads features: - one side machined/plugged for indicator

### Beta Rating

- Performance to  $\beta_{<6(c)} = 1000$

### Porting Size Options

- SAE-12 O-ring
- SAE-16 O-ring

### Replacement Filter Lengths

- 4.21" / 107 mm
- 8.23" / 209 mm

### Standard Bypass Ratings

- 50 psi / 345 kPa / 3.5 bar
- No bypass

### Assembly Weight

- Long Housing: 2.33 kg / 5.14 lbs
- Short Housing: 1.82 kg / 4.01 lbs

### Operating Temperatures

- -40° to 250°F (-40° to 121°C)

### Filter Collapse Ratings

- 145 psid / 1000 kPa / 10 bar (standard)



FLK90  
Max Flow: 40 gpm (151 lpm)



## FLK Specification Illustrations

### Long Assembly - Side View

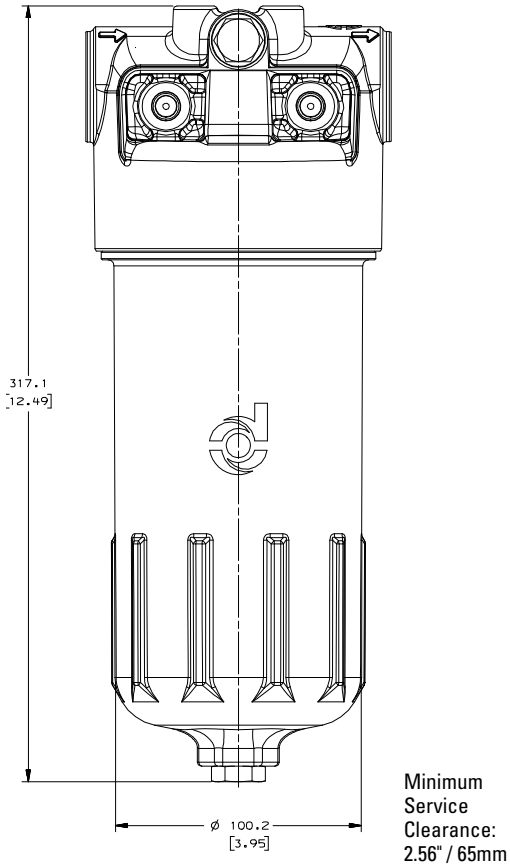

### Short Assembly - Side View

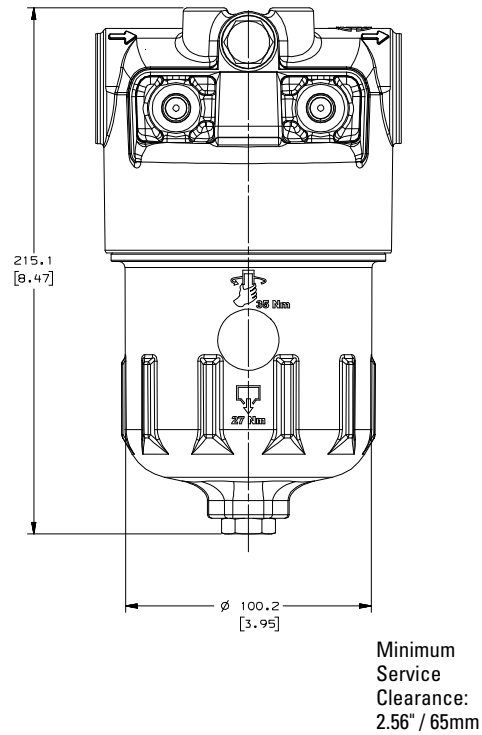

### Head - Top View

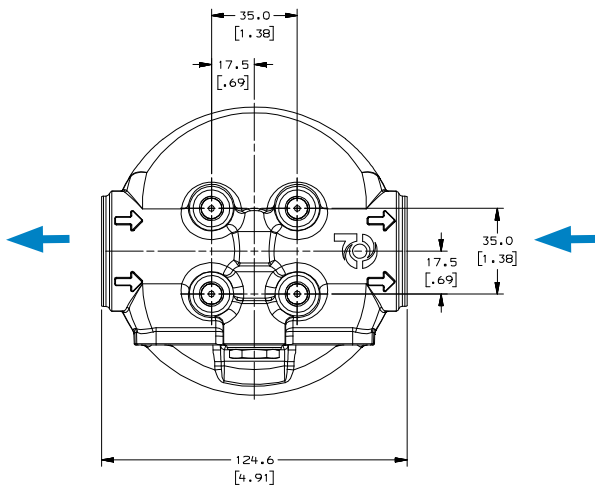

## FLK90 Components

### Head Choices

Part No.	Port Connections	Bypass Valve
P574994	SAE-12	50 psi (3.4 bar) bypass
P574995	SAE-12	No bypass
P574996	SAE-16	50 psi (3.4 bar) bypass
P574997	SAE-16	No bypass

### Housing Choices

Part No.	Comments
P766990	Short length assembly
P766961	Long length assembly

### Filter Choices

Media Type	$\beta_{x(c)} = 1000$ Rating based on ISO 16889	Length in mm	Donaldson Part No.
<b>Short Length Assembly</b>			
Synteq XP	6 $\mu$ m	4.21 107	P767128
Synthetic	11 $\mu$ m	4.21 107	P766987
	15 $\mu$ m	4.21 107	P767129
<b>Long Length Assembly</b>			
Synteq XP	6 $\mu$ m	8.23 209	P767130
Synthetic	11 $\mu$ m	8.23 209	P766959
	15 $\mu$ m	8.23 209	P767131

### Service Indicator Choices

Use with Bypass Valve Pressure of:	Indicator Part No.	Style <sup>2</sup>	Description
<b>Electric Models<sup>1</sup></b>			
50 psi / 345 kPa	P165194	A	Single post DC. N.O.
50 psi / 345 kPa	P574968	B	DC 2-wire.
50 psi / 345 kPa	P574967	E	DC 2-wire.
50 psi / 345 kPa	P575549	F	DC 3-wire.
50 psi / 345 kPa	P174396	C	AC/DC 3-wire.
25 psi / 172.5 kPa	P575334	H	Visual pop up
50 psi / 345 kPa	P575335	H	Visual pop up

#### Indicator Notes

<sup>1</sup>All electric models have a maximum operating temperature of 250°F / 121°C.

<sup>2</sup>Complete details on all service indicators can be found in the accessories section.

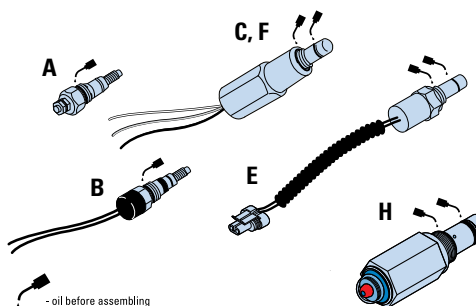

## Performance Data

**FLK90 Short Housing Only**

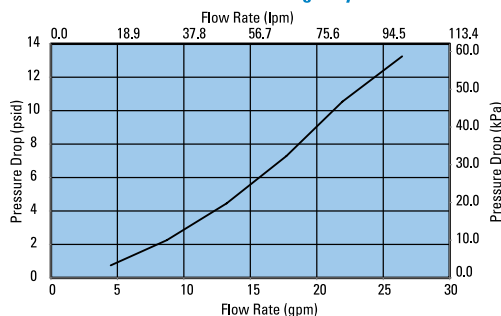

**FLK90 Long Housing Only**

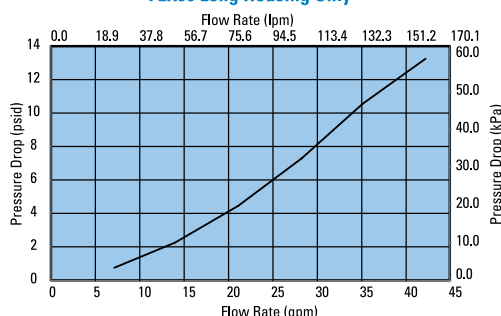

**FLK90 Short Filter only  
(Synthetic Media, 10.43"/265mm)**

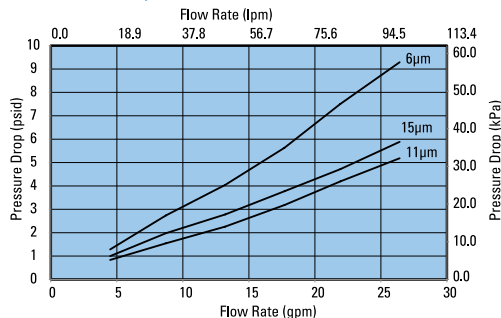

**FLK90 Long Filter only  
(Synthetic Media, 10.43"/265mm)**

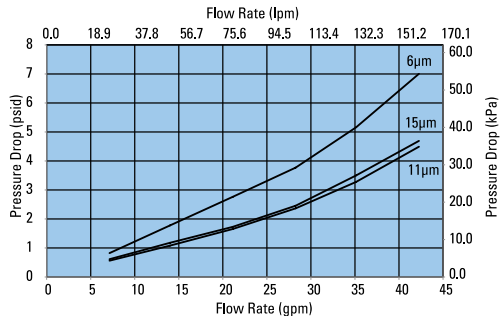



**FLK110**  
Max Flow: 42 gpm (159 lpm)



## FLK110 In-Line Cartridge Filters

**Working Pressures to:** 435 psi  
3001 kPa  
30 bar

**Rated Static Burst to:** 1300 psi  
8970 kPa  
90 bar

**Flow Range To:** 42 gpm  
159 lpm



### IMPORTANT SERVICE INSTRUCTIONS:

To prevent thread damage when installing new filter, fully lubricate the entire thread and o-ring surface with a Molybdenum-containing gear oil or anti-seize paste such as Schaeffer #214S Supreme One 80W-140 gear oil or Dow Corning Molykote P-37 anti-seize past.

## Features

The FLK assembly is a robust, reusable housing and disposable cartridge design. The versatile FLK filter head accommodates multiple housing lengths. Industrial, raised hand grips make it easy to remove the housing from the head without the need for special servicing tools. The oil drain port on the bottom of the housing and the locking grab handles on the filter cartridge allow for cleaner, easier servicing. The filter tabs lock into place – simplifying positioning during reassembly. Short removal clearance is needed for filter replacement means the assembly can easily fit into tight spaces.

These assemblies utilize a unique sealing technology that protects systems from harmful ingressed contaminants and cross contamination of oil. The RadialSeal™ interface increases the surface area which provides a robust connection with superior vibration resistance, a common challenge in today's heavy-duty applications.

The FLK filters are offered with Synteq XP™ media, Donaldson's most advanced media technology. Each filter has extended surface area for advanced filtration performance. Synteq XP delivers better pressure drop and better contaminant holding capacity than standard filter media.

- Robust 4-point mount
- Oil drain port
- Optional 2-point mount
- Heads features: - one side machined/plugged for indicator

### Beta Rating

- Performance to  $\beta_{<6(c)} = 1000$

### Porting Size Options

- SAE-20 O-ring

### Replacement Filter Lengths

- 7.4" / 187.9 mm
- 10.43" / 264.9 mm

### Filter Collapse Ratings

- 145 psid / 1000 kPa / 10 bar (standard)

### Standard Bypass Ratings

- 50 psi / 345 kPa / 3.5 bar
- No bypass

### Assembly Weight

- Long Housing: 1.34 kg / 2.95 lb
- Short Housing: 1.01 kg / 2.22 lb

### Operating Temperatures

- -40° to 250°F (-40° to 121°C)

## FLK Specification Illustrations

### Long Assembly - Side View

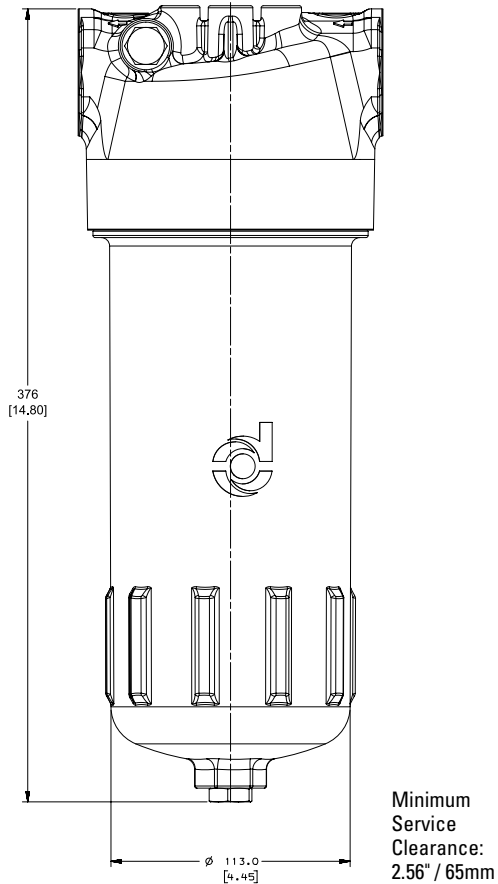

### Short Assembly - Side View

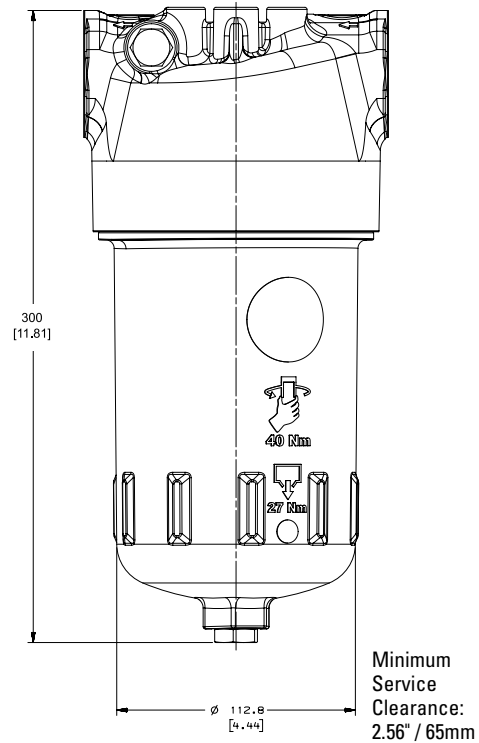

### Head - Top View

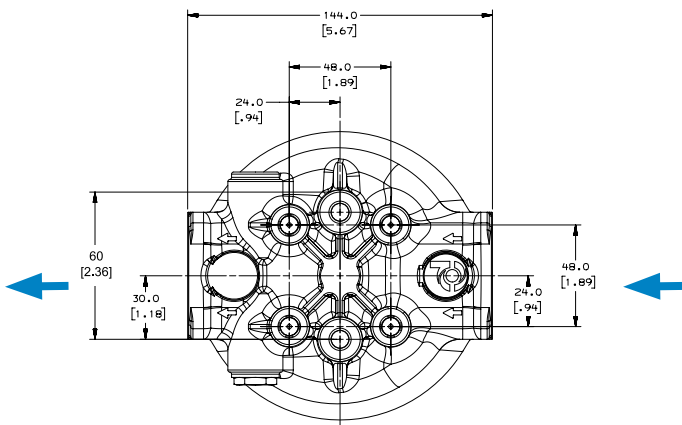

### Applications

- Hydrostatic Charge Pumps
- Hydrostatic Transmission
- Pilot Control Circuits



**FLK110**  
Max Flow: 42 gpm (159 lpm)



## FLK110 Components

### Head Choices

Part No.	Port Connections	Bypass Valve
P766831	SAE-20	50 psi (3.4 bar) bypass
P767009	SAE-20	No bypass

### Housing Choices

Part No.	Comments
P766812	Short length assembly
P766810	Long length assembly

### Filter Choices

Media	$\beta_{x(c)} = 1000$	Length		Donaldson
Type	Rating based on ISO 16889	in	mm	Part No.
Short Length Assembly				
Synteq XP	6 $\mu\text{m}$	7.4	187	P766847
Synthetic	11 $\mu\text{m}$	7.4	187	P766813
	15 $\mu\text{m}$	7.4	187	P767012
Long Length Assembly				
Synteq XP	6 $\mu\text{m}$	10.43	265	P767010
Synthetic	11 $\mu\text{m}$	10.43	265	P766811
	15 $\mu\text{m}$	10.43	265	P767011

### Service Indicator Choices

Use with Bypass	Indicator
Valve Pressure of:	Part No. Style <sup>2</sup> Description
<b>Electric Models<sup>1</sup></b>	
50 psi / 345 kPa	P165194 A Single post DC. N.O.
50 psi / 345 kPa	P574968 B DC 2-wire
50 psi / 345 kPa	P574967 E DC 2-wire
50 psi / 345 kPa	P575549 F DC 3-wire
50 psi / 345 kPa	P174396 C AC/DC 3-wire
25 psi / 172.5 kPa	P575334 H Visual pop up
50 psi / 345 kPa	P575335 H Visual pop up

#### Indicator Notes

<sup>1</sup>All electric models have a maximum operating temperature of 250°F / 121°C.

<sup>2</sup>Complete details on all service indicators can be found in the accessories section.

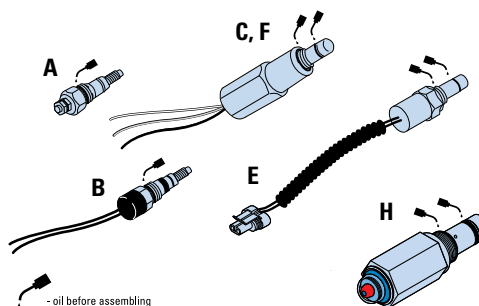

## Performance Data

**FLK110 Short Housing Only**

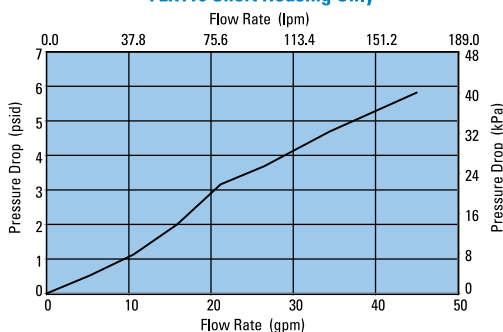

**FLK110 Long Housing Only**

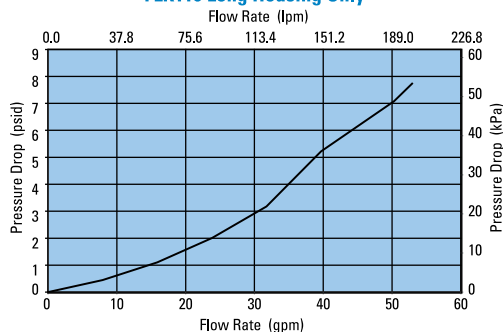

**FLK110 7" Filter Only**  
(Synthetic Synteq XP, 7.4"/187mm)

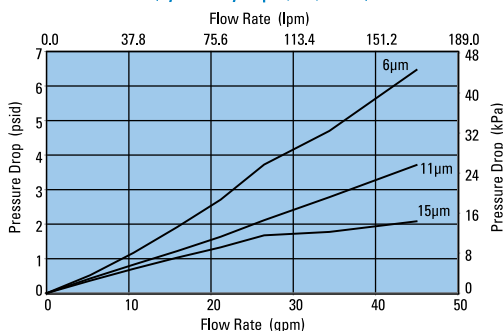

**FLK110 10" Filter Only**  
(Synthetic Synteq XP, 10.43"/265mm)

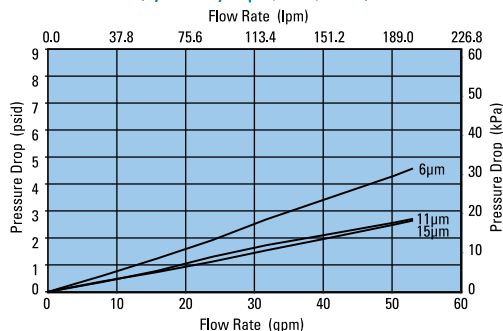

## FLK125 In-Line Cartridge Filters

**Working Pressures to:** 508 psi  
3505 kPa  
35.1 bar

**Rated Static Burst to:** 2000 psi  
13,790 kPa  
138 bar

**Flow Range To:** 85 gpm  
322 lpm

### Applications

- Hydrostatic Charge Pumps
- Hydrostatic Transmission
- Pilot Control Circuits



### IMPORTANT SERVICE INSTRUCTIONS:

To prevent thread damage when installing new filter, fully lubricate the entire thread and o-ring surface with a Molybdenum-containing gear oil or anti-seize paste such as Schaeffer #214S Supreme One 80W-140 gear oil or Dow Corning Molykote P-37 anti-seize past.

## Features

The FLK assembly is a robust, reusable housing and disposable cartridge design. The versatile FLK filter head accommodates multiple housing lengths. Industrial, raised hand grips make it easy to remove the housing from the head without the need for special servicing tools. The oil drain port on the bottom of the housing and the locking grab handles on the filter cartridge allow for cleaner, easier servicing. The filter tabs lock into place – simplifying positioning during reassembly. Short removal clearance is needed for filter replacement means the assembly can easily fit into tight spaces.

These assemblies utilize a unique sealing technology that protects systems from harmful ingressed contaminants and cross contamination of oil. The RadialSeal™ interface increases the surface area which provides a robust connection with superior vibration resistance, a common challenge in today's heavy-duty applications.

The FLK filters are offered with Synteq XP™ media, Donaldson's most advanced media technology. Each filter has extended surface area for advanced filtration performance. Synteq XP delivers better pressure drop and better contaminant holding capacity than standard filter media.

- Robust 4-point mount
- Oil drain port
- Optional 2-point mount
- Heads features: - one side machined/plugged for indicator

### Beta Rating

- Performance to  $\beta_{<6(c)} = 1000$

### Porting Size Options

- 2" SAE 4 bolt flange code 61

### Replacement Filter Lengths

- 10.85" / 275.7 mm

### Standard Bypass Ratings

- 50 psi / 345 kPa / 3.5 bar

### Assembly Weight

- Long Housing: 4.76 kg / 10.50 lbs

### Operating Temperatures

- -40° to 250°F (-40° to 121°C)

### Filter Collapse Ratings

- 145 psid / 1000 kPa / 10 bar (standard)



FLK125  
Max Flow: 85 gpm (322 lpm)



FLK Specification Illustrations

Long Assembly - Side View

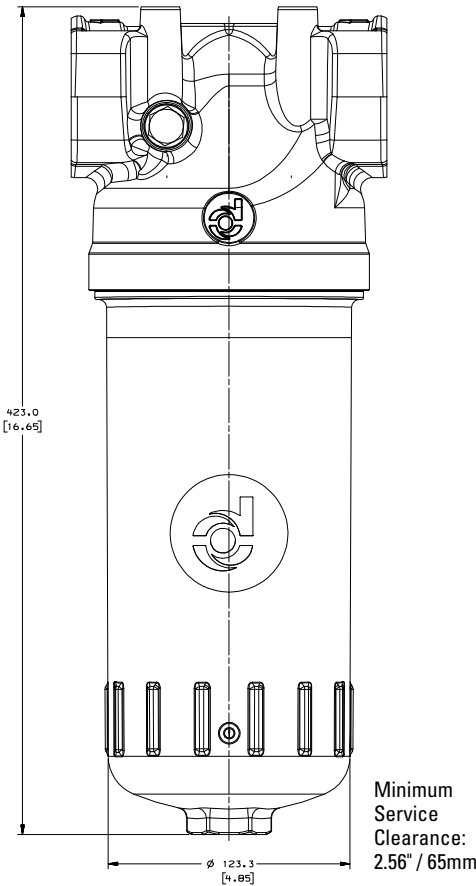

Head - Top View

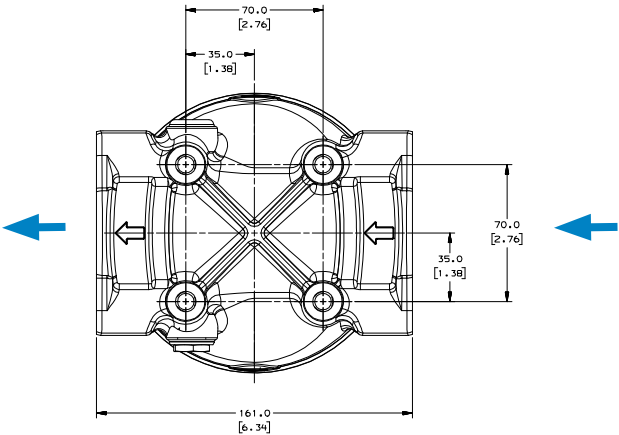



## FLK125 Components

### Head Choices

Part No.	Port Connections	Bypass Valve
P767095	2" SAE 4 bolt	50 psi (3.4 bar) bypass

### Housing Choices

Part No.	Comments
P767089	Long length assembly

### Filter Choices

Media	$\beta_{x(c)} = 1000$	Length		Donaldson
Type	Rating based on ISO 16889	in	mm	Part No.
Synteq XP	6 $\mu$ m	10.85	275.7	P767084
Synthetic	11 $\mu$ m	10.85	275.7	P767104
	15 $\mu$ m	10.85	275.7	P767106

### Service Indicator Choices

Use with Bypass	Indicator		
Valve Pressure of:	Part No.	Style <sup>2</sup>	Description
Electric Models <sup>1</sup>			
50 psi / 345 kPa	P165194	A	Single post DC. N.O.
50 psi / 345 kPa	P574968	B	DC 2-wire
50 psi / 345 kPa	P574967	E	DC 2-wire
50 psi / 345 kPa	P575549	F	DC 3-wire
50 psi / 345 kPa	P174396	C	AC/DC 3-wire
25 psi / 172.5 kPa	P575334	H	Visual pop up
50 psi / 345 kPa	P575335	H	Visual pop up

#### Indicator Notes

<sup>1</sup>All electric models have a maximum operating temperature of 250°F / 121°C.

<sup>2</sup>Complete details on all service indicators can be found in the accessories section.

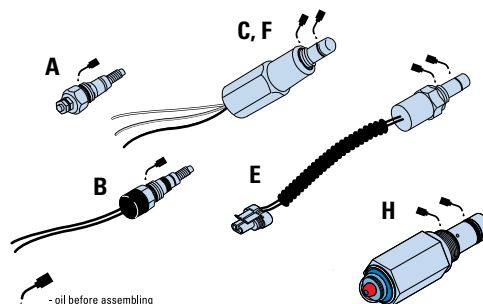

## Performance Data

