

# Pauluhn WashPro linear fluorescent luminaires

4L

Low bay luminaires for food and beverage and industrial locations

## Applications:

- Locations requiring continuous and consistent light levels
- Food and beverage processing and storage
- Power generation facilities
- Water/wastewater treatment facilities

## Features:

- High lumen output: up to 30,000 lumens
- Available in T8, T12 and T5HO fluorescent models
- NSF rated
- Operating ambient: -20°C to +55°C
- High pressure hose down rated to 1,500 PSI

## Certifications and compliances:

- UL1598 – Luminaires (CSA-US)
- UL924 – Emergency Lighting Equipment (CSA-US)
- CSA 22.2 No. 250-4
- Canadian Processed Products Regulations C.R.C., c.291
- NSF/ANSI 2-2010 Food Contact (WPS only)
- NSF/ANSI 2-2010 Splash Zone

## Photometrics:

- Refer to [www.eaton.com](http://www.eaton.com) (under the Resources tab of each product family) for specific photometric IES files



## Standard materials:

- Housing – end caps non-metallic or stainless steel (standard); polycarbonate center stud (optional)
- Lens – acrylic
- Gasket – neoprene
- External hardware – stainless steel

## Ordering information:

Part number example

WP82870EM2

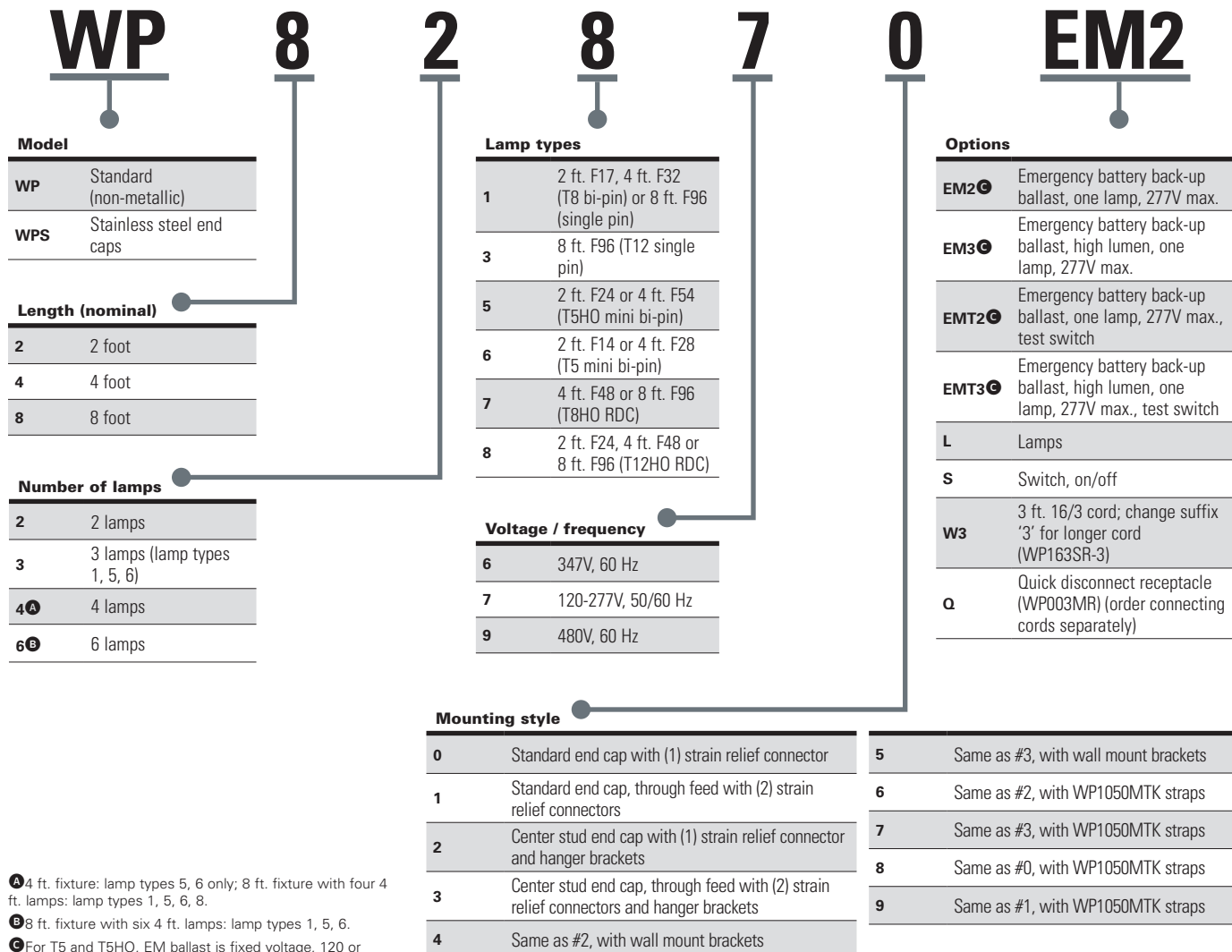

# Pauluhn WashPro linear fluorescent luminaires

4L

Low bay luminaires for food and beverage and  
industrial locations

## Mounting options and accessories:

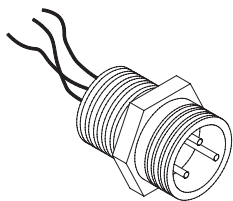

### WP003MR

Quick disconnect receptacle  
Required when WP163-6 cord  
assembly is used.

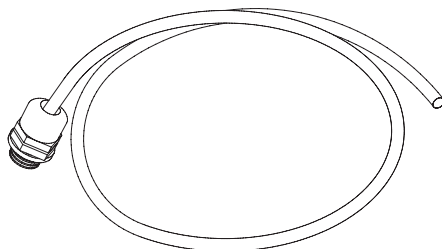

### WP163SR-6

Cord assembly  
Strain relief connector and 6  
feet of #16/3 cable. If longer  
cable is required, change '6'  
suffix to length needed.

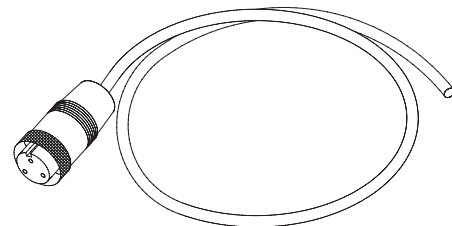

### WP163FP

Cord assembly  
Molded plug and 6 feet of  
#16/3 cable. If longer cable is  
required, change '6' suffix to  
length needed.

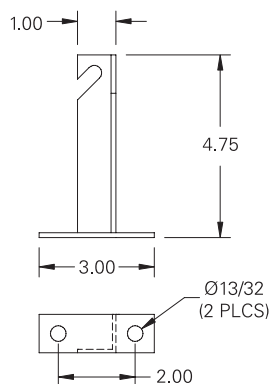

### FX7090

Wall mount bracket  
For center stud end caps.

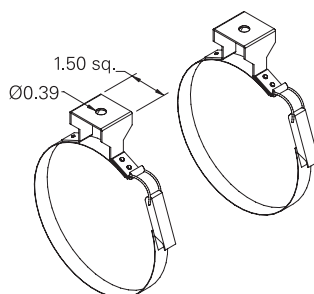

### WP1050MTK

Quick release stainless steel straps  
(2) included with mountings 6, 7, 8, 9.

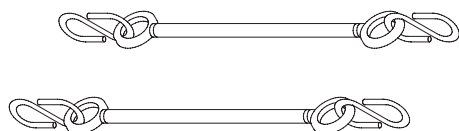

### WP1012MTK

Suspended cable kit  
(2) 12 inch nylon coated  
stainless steel cables with  
crimped-on loops; (2) "S" hooks.  
(if longer cable required, change  
'12' in catalog number to  
required length)

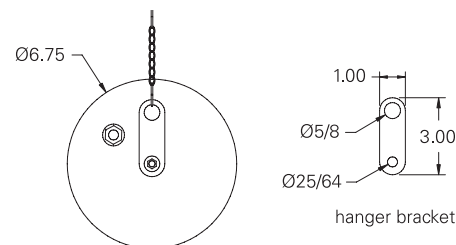
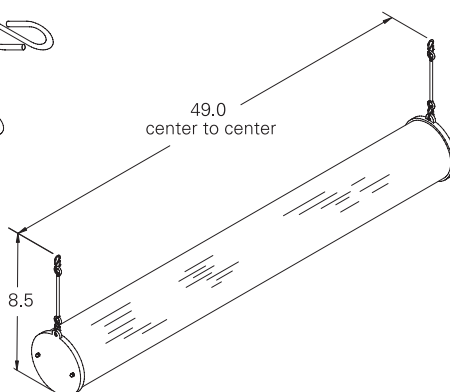

### Center stud end cap

Includes hanger bracket and  
stainless steel chain mount.  
(mountings 2 & 3)

Pauluhn WashPro linear  
fluorescent luminaires

4L

Low bay luminaires for food and beverage and industrial locations

Dimensions:

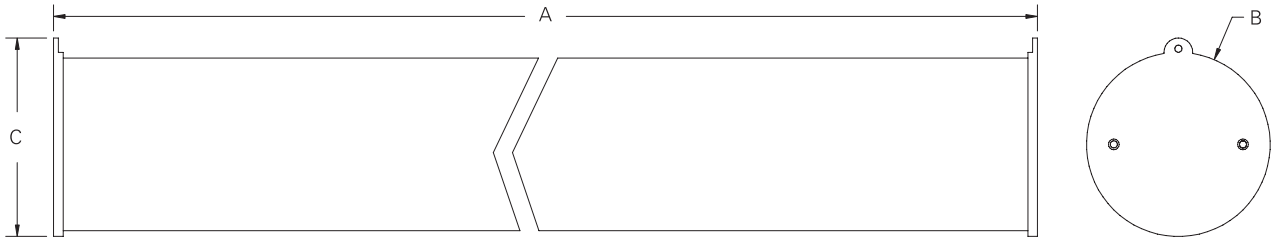

Nominal length	Dimensions in inches / centimeters			Carton W x D x L (in.)	Nominal weight	
	A	B	C		Lbs.	Kg.
2 foot	25.00 (63.50)	6.40 (16.30)	7.03 (17.86)	8 <sup>5</sup> / <sub>4</sub> x 6 <sup>1</sup> / <sub>4</sub> x 31 <sup>7</sup> / <sub>8</sub>	12.40	5.60
4 foot	49.00 (124.50)	6.40 (16.30)	7.03 (17.86)	8 x 8 x 51 <sup>1</sup> / <sub>4</sub>	20.30	9.20
8 foot	97.00 (246.40)	6.40 (16.30)	7.03 (17.86)	8 x 8 x 99 <sup>1</sup> / <sub>4</sub>	36.10	16.40